

## Connectors

Supporting base flange for FXT Heavy Rail Profiles

Material specifications	
Material	S235JR or equivalent steel
Coatings	Hot-Dip Galvanized



### Applications

- Secured mounting of FXT Heavy Rail Profiles

### Features & Benefits

- Increased flexibility during installation
- Ease of installation with less components
- Pre-assembled for rapid installation
- High load bearing capacity owing to special material properties and design
- Hot-dip galvanized in accordance to EN 1461 assures higher corrosion protection and provides flexibility of using in Indoors as well as outdoors

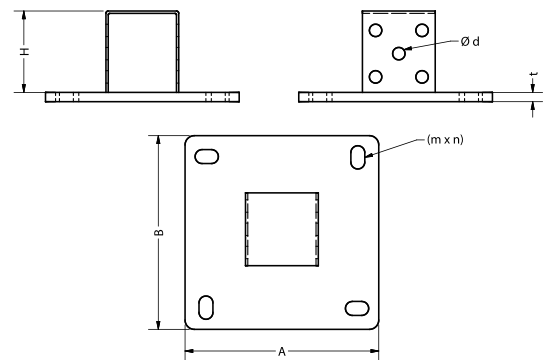

### Select Variant

Article No.	Product Description	FXT Heavy Rail Profile	A (mm)	B (mm)	Ø d (mm)	m x n (mm)	t (mm)	H (mm)
639001	FXT Base Flange, 80 80	80 80	200	200	14	14 X 25	10	105
639011	FXT Base Flange, 100 100	100 100	250	250	14	18 X 30	12	120
639021	FXT Base Flange, 100 120	100 120	250	250	14	18 X 30	12	145
639031	FXT Base Flange, 100 150	100 150	300	300	14	22 X 32	12	165