

## Connectors

Connection element for longitudinal alignment of FXC Mounting Channels

Material specifications	
<b>Material</b>	DD11 or equivalent steel
<b>Coatings</b>	Galvanized, Hot-Dip Galvanized (HDG), Powder Coating*, Zinc Magnesium*

### Applications

- Longitudinal connections of FXC Mounting Channels
- Maintaining continuity of FXC Mounting Channels for Large spans (e.g., In Pre-Engineered building structures)

### Features & Benefits

- Easy to install with less components
- Ensures longitudinal alignment of FXC Mounting Channels
- Four through bolts ensures safer connections

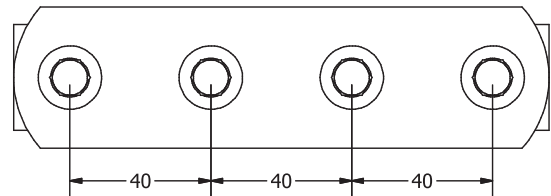
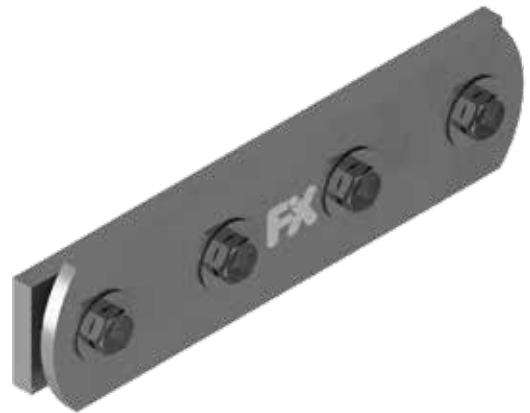

### Select Variant

Article No.		Product Description	Pack Size (Nos)
Galvanized (vz)	HDG (fvz)		
337700	337701	FXC Longitudinal Connector - 27 18, 28 30	50
337705	337706	FXC Longitudinal Connector - 38 24 - 40 80	25

\*Available on request