

## Mounting Channels

Universally slotted H-profile mounting channel

### Material specifications

<b>Material</b>	DX51D or Equivalent steel DD11 or Equivalent steel
<b>Coatings</b>	Galvanized, Hot-Dip Galvanized (HDG), Powder Coating*, Zinc Magnesium*



### Applications

- Installation of medium to heavy-duty ventilation ducts, plumbing & firefighting pipes and cable trays
- Secondary support structure for installation of different services

### Features & Benefits

- Wide range of mounting options in conjunction with our FXC mounting channel accessories
- Quick and efficient attachment of multiple support structure
- Lateral and vertical adjustment with reliable fastening
- High load bearing capacity owing to special material properties and design

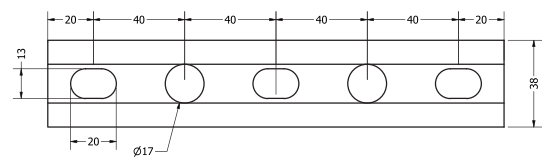
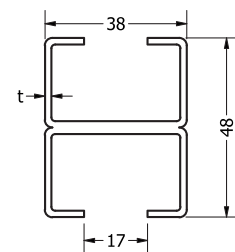

### Select Variant

Article No.		Product Description	L (mm)	W (mm)	H (mm)	t (mm)
Galvanized (vz)	HDG (fvz)					
300170	300171	FXC Mounting Channel 38 48 1.75, 6 m	6000	38	48	1.75
300180	300181	FXC Mounting Channel 38 48 1.75, 3 m	3000	38	48	1.75
300190	300191	FXC Mounting Channel 38 48 1.75, 2 m	2000	38	48	1.75

\*Available on request